

VIVE

living



Computer Generated Image

2 Bedroom Apartment

Total area: 72.7 sqm/782 sqft

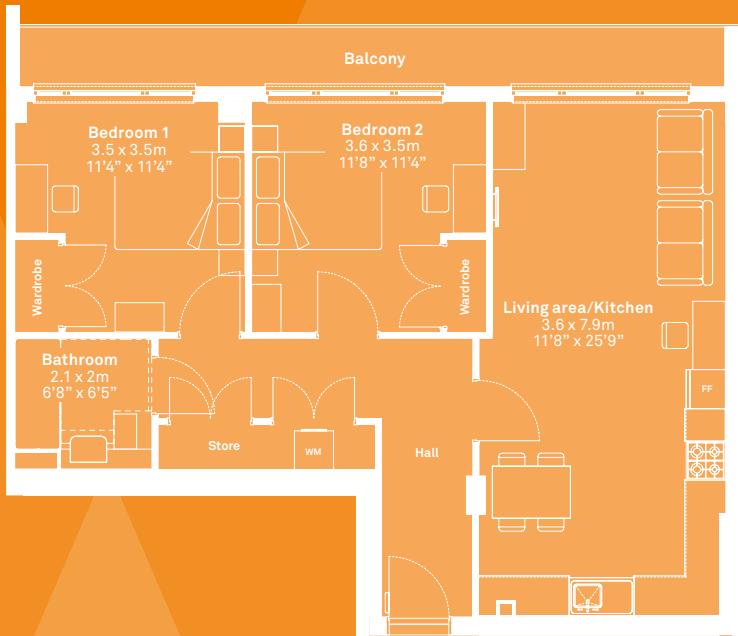

Type 12



- 2 bedroom, 1 bathroom
- Underfloor heating throughout
- Floor to ceiling glazing leading to full width balcony
- Built-in storage
- Excelsior white gloss kitchen – integrated BOSCH appliances
- Karndean oak flooring in living areas; soft carpets in the bedrooms
- Roca bathrooms and Hansgrohe taps as standard (we have high standards)

Every apartment has full access to: bike storage and repair, co-working spaces, a cinema, café, roof terrace, ping pong tables, an in-house app helping you sort it all out, Sonos music systems, an on site relationship manager, dedicated maintenance under one roof and 1GB Broadband available

T: 020 3757 5878

E: hello@viveliving.co.uk